

CT1 Divider

Solid Surface Counter Divider

The CT1 Divider provides an easily installed temporary solution for social separation on your counter surfaces without sacrificing space for distancing. The CT1 Divider may be installed at vanity sink counter tops, trough sink counter tops, and any counter surface backed by a wall.

Features & Benefits

- Corian® solid surface material
- Durable
- Non-porous
- Easy to clean, bleach safe
- Class A fire rated
- All aluminum hardware
- Easy installation
- One size fits all
- Adhesive attachment, no drilling
- Removable, non-damaging
- Reusable

Pricing

Divider CT1, Standard color and size:
 1 to 20 units: \$290
 20 to 100 units: \$285
 >100 units: \$275
 Prices do not include shipping.

Ships in 7 to 10 days from date of order.

For alternate colors and fit, contact Artisan Display Inc. for an estimate. Lead times may vary.

Warranty

90 day warranty covers manufacturer defects above and beyond normal wear and tear.

How to order

- Measure your installation location
- Fill out and submit the order sheet
- or-
- Email or call Artisan Display Inc. Contact:
 Mike Goodwin
 mgoodwin@artisandisplayinc.com
 215-679-8577

Fit

The CT1 Divider fits a standard counter top up to 25". If a different size is needed, or if you would like the panel to fit your counter specifically, the CT1 Divider provides flexibility to be fabricated to size. Note that counter surfaces must have a back wall for installation.

Each assembled panel weights approximately 32 pounds.

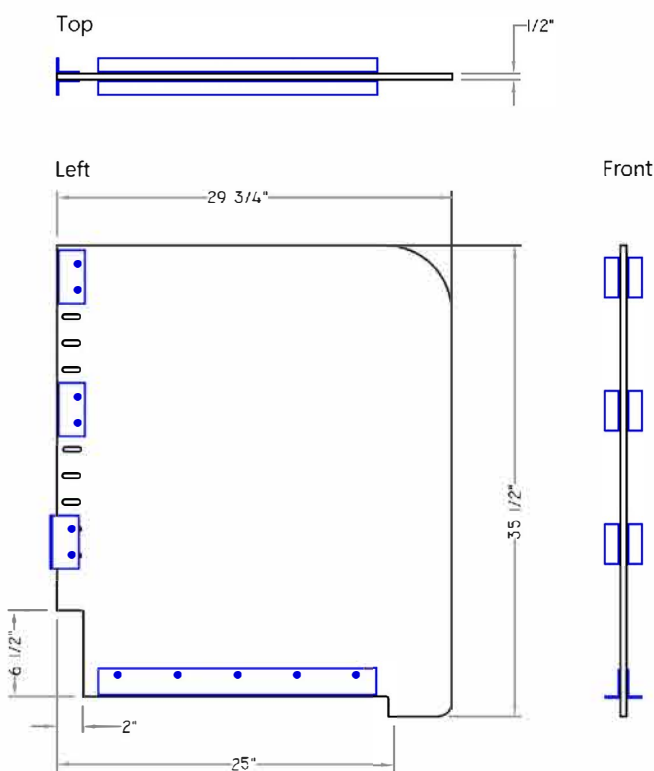

Colors



The CT1 Divider comes in Corian® Glacier White. Other colors may be chosen from the full library of current Corian® colors or Alyn resin colors below. Colors other than Glacier White will come at additional cost depending on the chosen color.

Alyn Translucent Resin

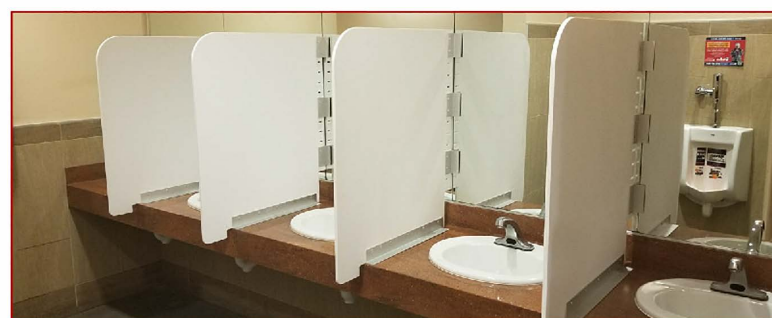
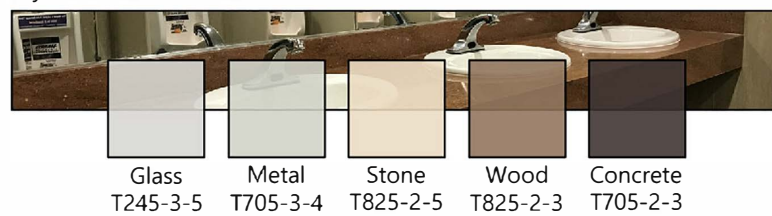

Resources

- Order Form
- Measuring Instructions
- Installation Video
- Installation Instructions
- CAD files (DXF)

Corian® is a registered trademark of DuPont de Nemours, Inc.